

MEET YOUR X5-EVO

What's in the box?

- Smart Video Cycling Computer X5-Evo
- Micro-USB Cable
- Warranty Card
- Heart Rate Sensor (Optional)
- Extended out-front Bike Mount Kit
- Quick Start Guide
- Strap
- Speed/Cadence Combo Sensor (Optional)

NOTE:

- Use only approved accessories.
- Accessories may vary by country or region.
- For more detailed information on the use and care of your Heart Rate and Combo Sensor, please refer to User's Manual.

Part names and functions

1. POWER

- Short press: suspend/wakeup screen
- Long press: power on/off

2. BACK/LAP

- BACK: press it to return to previous page when not in riding mode
- LAP: press it to start a new lap during riding mode

3. START/STOP

- Short press: start/stop riding
- Long press: switch to Bike mode

4. Touchscreen

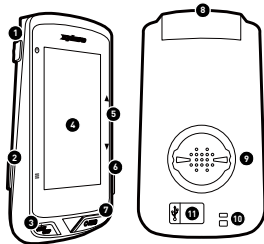

5. UP/DOWN

- Zoom in/out in Map mode
- Change datasheet in Data mode

6. Slot (not supported)

7. REC

- Short press: start/stop video recording
- Long press: switch to Record mode

8. Camera

9. Bike mount latch

10. Strap hole

Fasten the strap to the handlebars to enhance security during riding

11. Micro USB port

Tighten the weather cap for the USB port to ensure water resistance

Charging the X5-Evo to 100%

For initial use, you need to charge the built-in battery (by the provided USB cable) for at least 5 hours. To prevent corrosion, thoroughly dry the Micro USB port, weather cap and the surrounding area before charging or connecting to a computer.

Please pull out the weather cap from the Micro USB port with care to avoid breakage. When charging process is completed, please ensure to put it back in snugly.

NOTE

- The X5-Evo can be charged while using. Please be aware that the Micro USB port is not water-resistant. Do not attempt to charge X5-Evo in the rain or excessive moisture conditions.
- The operating temperature range for X5-Evo is from -10°C to 50°C .
- Do not leave X5-Evo in high temperature (over 60°C) and damp environments.

Installing the X5-Evo on the bike

1. Attach the Extended Out-Front Bike Mount on the bike handlebar. Align it with the bike stem and tighten the screw. Ensure that the mount is securely locked and parallel with the ground level toward the front.
2. Hold X5-Evo firmly and turn it toward the right. Place it horizontally on the mount notch and press downward slightly.
3. Turn 90-degrees counterclockwise to lock it on the bike mount.
4. Eventually X5-Evo is parallel to your stem. You can operate with ease.

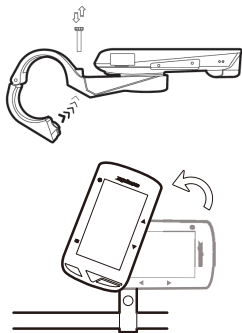

Performing the initial Setup

Press and hold the [POWER] button to activate X5-Evo and follow the on-screen instructions to personalize your computer profile and configure system settings.

Pre-Ride Setting

Please set the basic settings in advance to get more accurate ride information from X5-Evo.

- Connect to a Wi-Fi network: Settings > Network > Wi-Fi.
- Locate your GPS: Settings > System > GPS > activate GPS. (It is recommended to locate your GPS in an open area.)
- Pair your X5-Evo with optional ANT+ Sensors (if available): Settings > ANT+.
- Altitude Calibration: Settings > Device > Altitude Calibration.





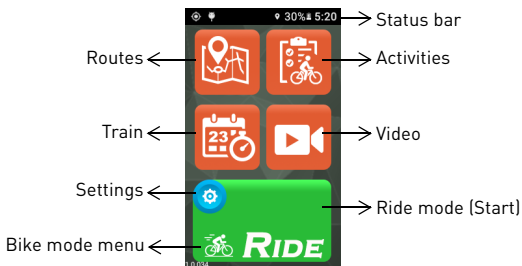

LET'S GO FOR A RIDE

Home screen overview





The home screen provides quick access to features and settings.



Start/Stop a ride

1. From the home screen, specifically tap on the bike icon  on the [RIDE] button to bring up Bike Mode menu (or long press [START/STOP] button). There are four different bike modes for selection: Road (default) , Downhill Off-Road , Leisure ride  and Indoor . Choose the most applicable to your need.
2. Tap [RIDE] button to start riding (or short press [START/STOP] button).
3. During riding, you can:
 - tap screen to stop timer or lap. Or
 - short press [LAP] button to lap. Or
 - short press [START/STOP] button to continue/save/discard the riding.
4. When timer is stopped, tap screen again to continue/save/discard the riding (or short press [START/STOP] button to resume timer).
5. Swipe down from the top of the screen to access the Quick Access Menu and tap  to close it.
6. Swipe left or right to view other data pages.

Camera recording setup

X5-Evo supports four types of camera recording. Long press [REC] button to bring up the Record mode menu: [Auto] , [Recycle] , [Time-lapse]  and [Manual] . Select one in which you are interested. Short press [REC] button to start/stop recording.

View activities

1. From the home screen, tap  to view recorded activities.
2. Select an activity. From the selected activity page, you will see the overview of the data from the ride.

Get your routes ready and start training yourself

Would you like to create/plot your own bike routes or discover new ones? With Xplova CONNECT app, you can easily draw your own routes, or simply download routes for your X5-Evo. In addition, Xplova CONNECT app also allows you to customize your training schedule and workout plans, helping you to achieve your cycling goals more effectively.

More exciting features

To maximize your X5-Evo's availability/functionality, it is strongly recommended that you install our two apps in your smartphone:

1. You can use Xplova CONNECT to:
 - View/store activities from X5-Evo.
 - Download routes from websites.
 - Create/send routes/training plans to X5-Evo.
 - Upload your activities/routes on different platforms (e.g., Xplova, Strava and others).
2. You can use Xplova VIDEO to:
 - View/store videos from X5-Evo.
 - Video editing and production.
 - Overlay activity stats onto video.
 - Post videos to social networks.

Open your smartphone's application store (Google Play or App Store) and search for "Xplova VIDEO" or "Xplova CONNECT". Download and install the applications.



Find more information

Please scan below QR codes for further information about X5-Evo.



Xplova Website



User Manual



Service information